

Orientation Lead Impression Block

The Hunting Orientation Lead Impression block is designed to allow the operator to take an impression of an unknown object and determine how it is lying within the tubing string in a deviated well. The double impression definition helps the operator to select the appropriate tool for the next operation, to accomplish the desired objective.

An orientation lead impression block consists of a cylindrical steel container with an open bottom end which is filled with soft lead. A steel ball, captive within the body of this tool provides the upper part of the 'double impression' which identifies the low side of the well. This permits a comparison between impression of fish and the 'low side'.

Various diameters are available to suit operational requirements.

 The double impression definition helps the operator to select the appropriate tool for the next operation, to accomplish the desired objective.

ORIENTATION LEAD IMPRESSION BLOCK			
Size Range	Fishing Neck	Connection	Part Number
1.375 - 1.500"	1.375"	15/16 - 10	126-XXXX-005
1.500 - 2.000"	1.375"	15/16 - 10	126-XXXX-005
2.000 - 2.500"	1.750"	1-1/16 - 10	126-XXXX-005
2.500 - 4.000"	1.750"	1-1/16 - 10	126-XXXX-005
4.000 - 5.500"	2.313"	1-1/16 - 10	126-XXXX-005
5.500 - 6.000"	2.313"	1-9/16 - 10	126-XXXX-005

4.562" Orientation Lead Impression Block would be 126-4562-005
 Bespoke sizes available on request.

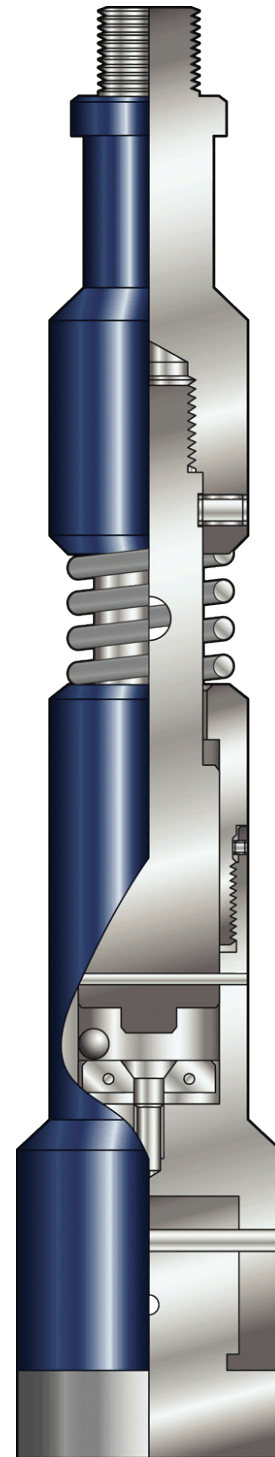

Wireline Operations - Slickline Tools



Available Connections

